



Republic of the Philippines
 Department of Agriculture
Philippine Center for Postharvest Development and Mechanization
 Science City of Muñoz, Nueva Ecija
www.philmech.gov.ph
 ISO 9001:2015, ISO 14001:2015, ISO 45001:2018 CERTIFIED



BIDS AND AWARDS COMMITTEE

SUPPLEMENTAL BID BULLETIN NO. 1

**SUPPLY, DELIVERY AND TESTING OF MECHANICAL RICE TRANSPLANTERS
 (FY 2024 Early Procurement)
 (PHilMech-RCEF-23-11-28)**

This **Supplemental/Bid Bulletin No. 1** is being issued to clarify, amend and supplement provisions in the Bidding Documents.

A. ISSUES AND CONCERNS DURING THE PRE-BID CONFERENCE

1. <i>Issue / Proposal: Request for the low-bed trailer sample picture.</i>
<i>Action Taken/Reply: sample picture of the low-bed trailer is hereby attached as Annex A.</i>

B. WRITTEN QUERIES/ COMMENTS/REQUEST

1. <i>Issue / Proposal: Request the adaptation of the 120-calendar-day delivery period adopted in the previous Mechanical Rice Transplanter procurement project instead of 90 calendar days.</i>																						
<i>Answer/Action Taken/Reply: Request/proposal is granted. Delivery period is amended to 120 calendar days.</i>																						
	<i>FROM</i>	<i>TO</i>																				
<i>Invitation To Bid</i>	<i>2. The PHilMech now invites bids from eligible bidders for the SUPPLY, DELIVERY AND TESTING OF MECHANICAL RICE TRANSPLANTERS. Delivery of the GOODS is required within Ninety (90) calendar days from receipt of the Notice to Proceed. Bidders should have completed within ten (10) years from the date of submission and receipt of bids a contract similar to the project. For this purpose, a similar contract shall refer to any contract for the Supply and Delivery of Agricultural Machine/s.</i>	<i>2. The PHilMech now invites bids from eligible bidders for the SUPPLY, DELIVERY AND TESTING OF MECHANICAL RICE TRANSPLANTERS. Delivery of the GOODS is required within One Hundred Twenty (120) calendar days from receipt of the Notice to Proceed. Bidders should have completed within ten (10) years from the date of submission and receipt of bids a contract similar to the project. For this purpose, a similar contract shall refer to any contract for the Supply and Delivery of Agricultural Machine/s.</i>																				
<i>Schedule of Requirements</i>	<table border="1"> <thead> <tr> <th>Item Number (LOT No.)</th> <th>Delivered, Weeks/Months</th> </tr> </thead> <tbody> <tr> <td>1</td> <td>90CD</td> </tr> <tr> <td>2</td> <td>90CD</td> </tr> <tr> <td>3</td> <td>90CD</td> </tr> <tr> <td>4</td> <td>90CD</td> </tr> </tbody> </table>	Item Number (LOT No.)	Delivered, Weeks/Months	1	90CD	2	90CD	3	90CD	4	90CD	<table border="1"> <thead> <tr> <th>Item Number (LOT No.)</th> <th>Delivered, Weeks/Months</th> </tr> </thead> <tbody> <tr> <td>1</td> <td>120CD</td> </tr> <tr> <td>2</td> <td>120CD</td> </tr> <tr> <td>3</td> <td>120CD</td> </tr> <tr> <td>4</td> <td>120CD</td> </tr> </tbody> </table>	Item Number (LOT No.)	Delivered, Weeks/Months	1	120CD	2	120CD	3	120CD	4	120CD
Item Number (LOT No.)	Delivered, Weeks/Months																					
1	90CD																					
2	90CD																					
3	90CD																					
4	90CD																					
Item Number (LOT No.)	Delivered, Weeks/Months																					
1	120CD																					
2	120CD																					
3	120CD																					
4	120CD																					

Main Office: CLSU, Science City of Muñoz, Nueva Ecija, Philippines
 Mobile Nos.: (+63) 917-800-4526/ (+63) 917-813-0852

Liaison Office: 3rd Floor, ATI Bldg., Elliptical Road, Diliman, Quezon City



	5	90CD	5	120CD
	6	90CD	6	120CD
<p>2. Issue / Proposal: Request that the BAC consider adopting back the required quantities of seedling trays, i.e., 1500 pieces for Walk Behind and 2,500 pieces for the Riding Type.</p> <p>Answer/Action Taken/Reply: The requirement is retained.</p>				
<p>3. Issue / Proposal: On the Item 6 for Certifications requirement (for walk-behind and riding type transplanters) under the issuance of Certification of Very Satisfactory Performance, do we have to submit a certificate both issued by an individual customer and government/private company/agency OR either of the two may suffice?</p> <p>Answer/Action Taken/Reply: Either a certification from an individual customer or government/private company/agency may suffice for the requirement. The requirement is restated for clarity.</p>				
	FROM		TO	
<p>Technical Specifications (For Walk Behind Mechanical Rice Transplanters)</p>	<p>6. Certification of Very Satisfactory Performance of the Walk Behind Mechanical Rice Transplanter being offered as to: i) Machinery Performance; ii) Machinery Durability; and, iii) Availability of Parts and Service.</p> <p><u>Who may issue:</u></p> <ul style="list-style-type: none"> - At least one (1) individual customer or client with complete address and telephone number. - Any government or private agency/company, duly signed by the current head of agency/company within the last one (1) year. <p><u>Excluding the following:</u></p> <ul style="list-style-type: none"> - PHilMech - Bidder's Dealers and Authorized Service Centers 		<p>6. Certification of Very Satisfactory Performance of the Walk Behind Mechanical Rice Transplanter being offered as to: i) Machinery Performance; ii) Machinery Durability; and, iii) Availability of Parts and Service.</p> <p><u>Who may issue:</u></p> <ul style="list-style-type: none"> - At least one (1) individual customer or client with complete address and telephone number within the last one (1) year; or - Any government or private agency/company, duly signed by the current head of agency/company within the last one (1) year. <p><u>Excluding the following:</u></p> <ul style="list-style-type: none"> - PHilMech - Bidder's Dealers and Authorized Service Centers 	
<p>Technical Specifications (For Riding Type Mechanical Rice)</p>	<p>6. Certification of Very Satisfactory Performance of the Riding Type Mechanical Rice Transplanter being offered as to: i) Machinery Performance; ii) Machinery Durability; and, iii) Availability of Parts and Service.</p>		<p>6. Certification of Very Satisfactory Performance of the Riding Type Rice Transplanter being offered as to: i) Machinery Performance; ii) Machinery Durability; and, iii) Availability of Parts and Service.</p>	

Main Office: CLSU, Science City of Muñoz, Nueva Ecija, Philippines
 Mobile Nos.: (+63) 917-800-4526/ (+63) 917-813-0852

Liaison Office: 3rd Floor, ATI Bldg., Elliptical Road, Diliman, Quezon City



Transplanters)	<p><i>Service.</i></p> <p><u>Who may issue:</u></p> <ul style="list-style-type: none"> - At least one (1) individual customer or client with complete address and telephone number. - Any government or private agency/company, duly signed by the current head of agency/company within the last one (1) year. <p><u>Excluding the following:</u></p> <ul style="list-style-type: none"> - PHilMech - Bidder's Dealers and Authorized Service Centers 	<p><u>Who may issue:</u></p> <ul style="list-style-type: none"> - At least one (1) individual customer or client with complete address and telephone number <u>within the last one (1) year; or</u> - Any government or private agency/company, duly signed by the current head of agency/company within the last one (1) year. <p><u>Excluding the following:</u></p> <ul style="list-style-type: none"> - PHilMech - Bidder's Dealers and Authorized Service Centers
----------------	--	---

Issued this 24th day of November 2023 in the Science City of Muñoz, Nueva Ecija, Philippines.

Reviewed and approved by:

NELSON C. SANTIAGO, Ph.D.
 Chairperson, Bids and Awards Committee

RAYMUND JOSEPH P. MACARANAS
 Vice Chairperson

JERRY F. AVELLANOZA
 Regular Member

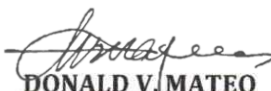
DONALD V. MATEO
 Technical Member

MR. BENNY P. RODEROS
 End-User/Provisional Member

CONFORMED: _____ Bidders Name: _____ Date Received: _____

Main Office: CLSU, Science City of Muñoz, Nueva Ecija, Philippines
 Mobile Nos.: (+63) 917-800-4526/ (+63) 917-813-0852

Liaison Office: 3rd Floor, ATI Bldg., Elliptical Road, Diliman, Quezon City



Republic of the Philippines
Department of Agriculture
Philippine Center for Postharvest Development and Mechanization
Science City of Muñoz, Nueva Ecija
www.philmech.gov.ph
ISO 9001:2015, ISO 14001:2015, ISO 45001:2018 CERTIFIED



ANNEX A.

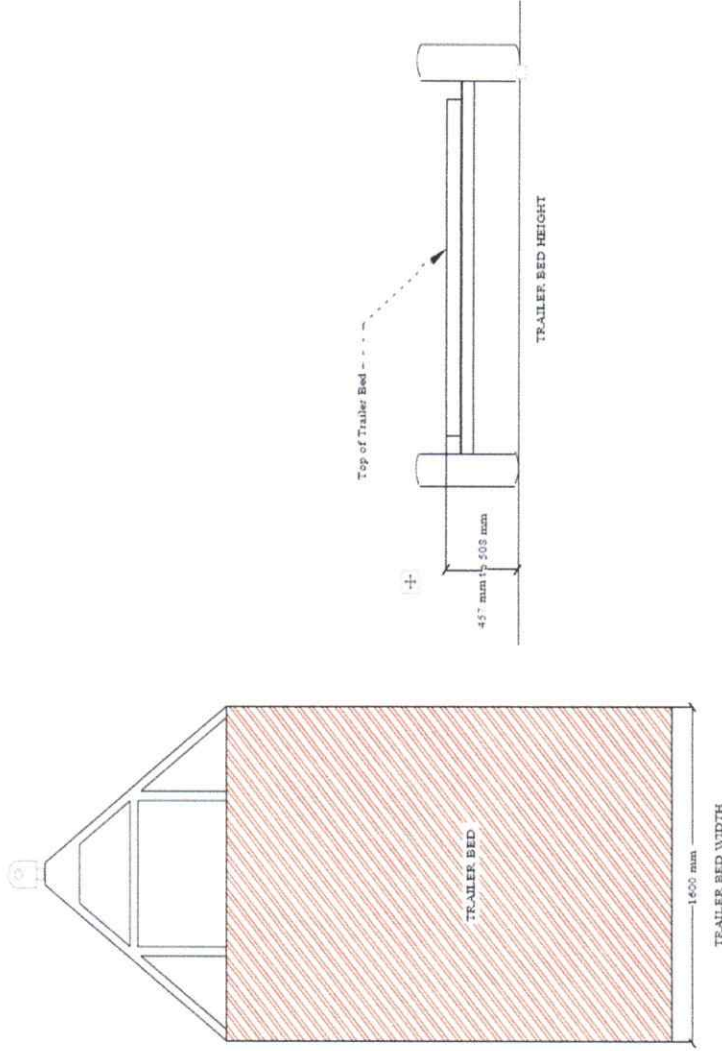

PROPOSED WIDTH AND HEIGHT OF TRAILER BED OF WALK BEHIND TRANSPLANTER

Main Office: CLSU, Science City of Muñoz, Nueva Ecija, Philippines
Mobile Nos.: (+63) 917-800-4526 / (+63) 917-813-0852

Liaison Office: 3rd Floor, ATI Bldg., Elliptical Road, Diliman, Quezon City

PHilMech-AD-F-192 Rev 01 (07.20.23)



Republic of the Philippines
 Department of Agriculture
Philippine Center for Postharvest Development and Mechanization
 Science City of Muñoz, Nueva Ecija
www.philmech.gov.ph
 ISO 9001:2015, ISO 14001:2015, ISO 45001:2018 CERTIFIED

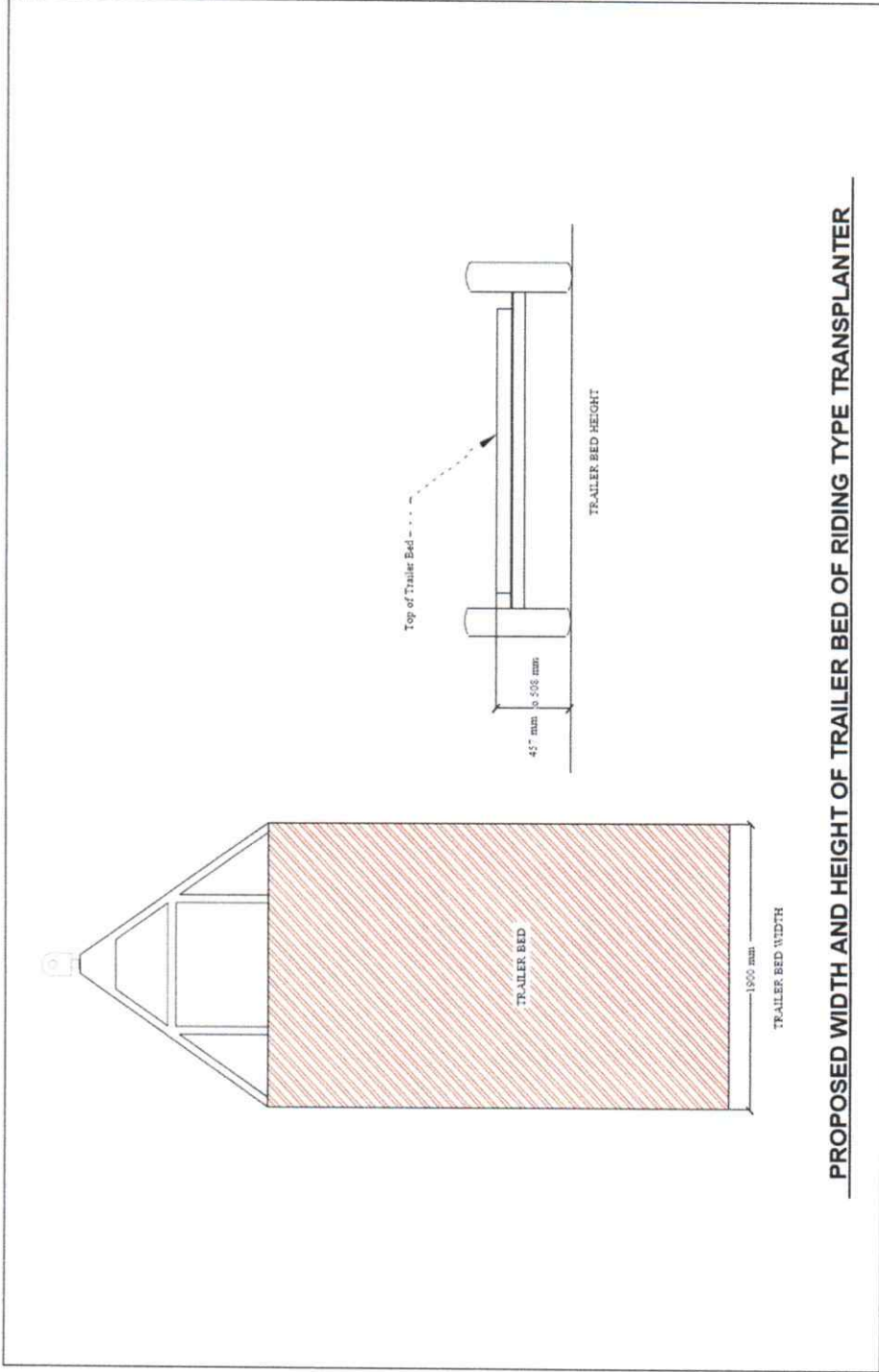

PROPOSED WIDTH AND HEIGHT OF TRAILER BED OF RIDING TYPE TRANSPLANTER

Main Office: CLSU, Science City of Muñoz, Nueva Ecija, Philippines
 Mobile Nos.: (+63) 917-800-4526 / (+63) 917-813-0852

Liaison Office: 3rd Floor, ATI Bldg., Elliptical Road, Diliman, Quezon City
 PHilMech-AD-F-192 Rev 01 (07.20.23)